

Index

Bridges

Quickspan Bridge-CHBDC & CSAS6-14

Arch Bridge-CHBDC & CSA S6-1

Precast Deck Panels

F

F-1

F-2

F-3



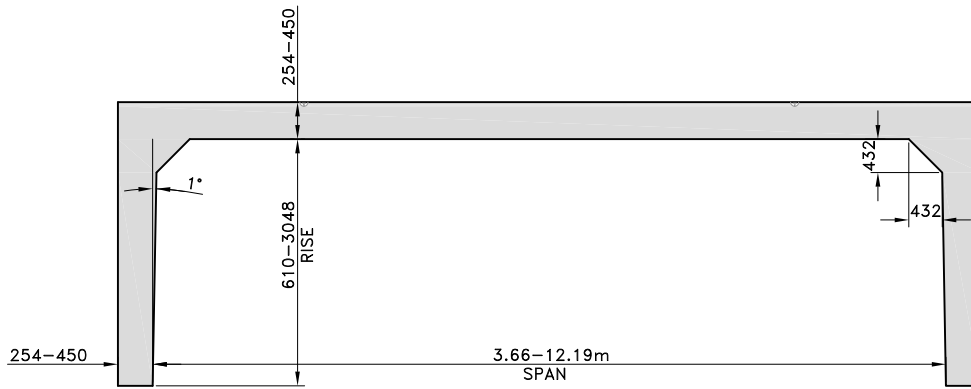

TYPICAL BRIDGE SECTION
FRONT VIEW

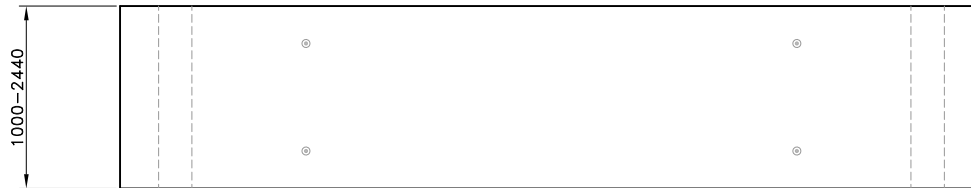

TYPICAL BRIDGE SECTION
PLAN VIEW

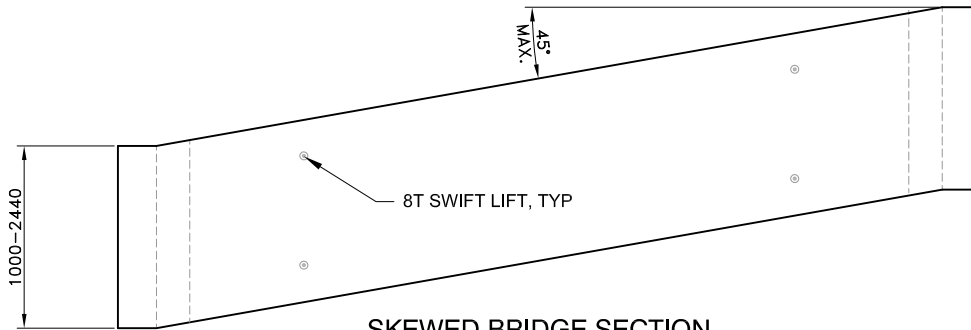

SKEWED BRIDGE SECTION
PLAN VIEW

NOTES:

1. Designed to CHBDC CSA S6.
2. Footings can be precast with the engineer's approval.
3. Wingwalls are available with variable slopes.
3. Maximum weight per piece is 22 tonnes.
4. Dimensions will vary with soil conditions.
5. For special designs please contact our Engineering Department.
6. All dimensions are in millimeters, unless otherwise shown.

The product information contained in this document is believed to be accurate. Please note that not all products are made at all our facilities. For more information, specifics, and product availability, please contact your local sales representative.

© 2024 Rinker Materials

Rinker 013 - 03/2024

TITLE		PLANT	PROVINCE	DATE	SECTION PAGE
QuickSpan Bridge		CAMBRIDGE OTTAWA	ON	2024	F-1



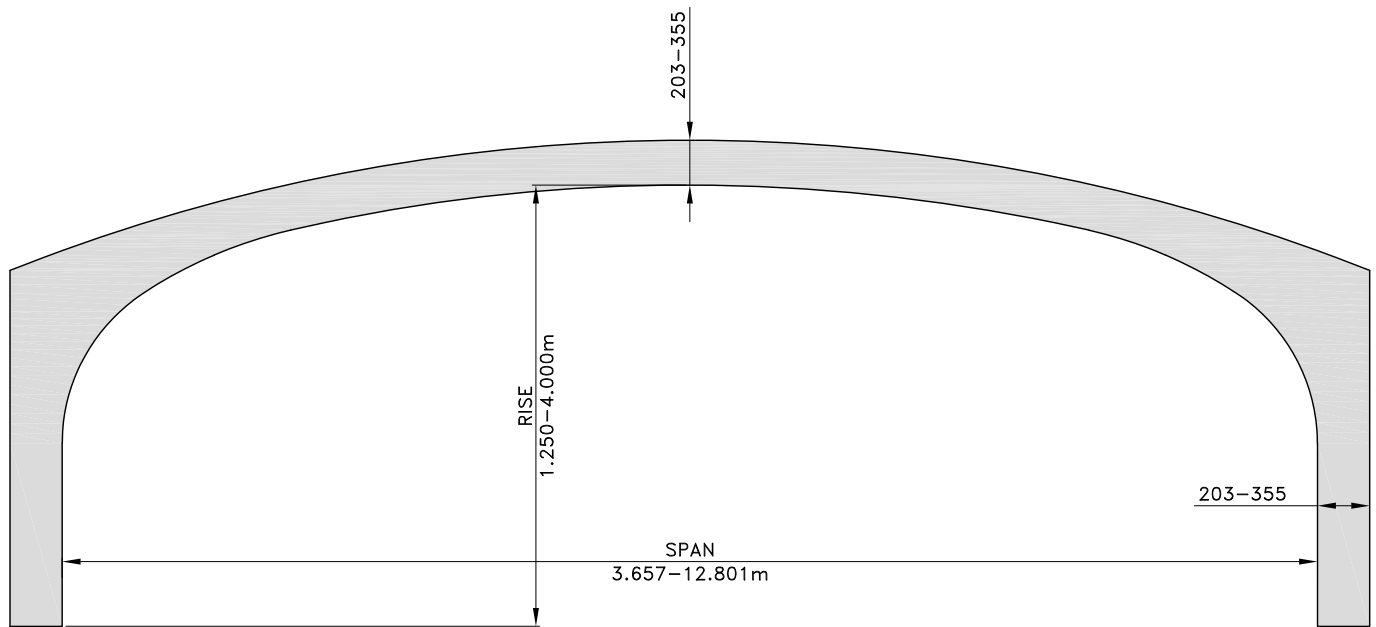

TYPICAL BRIDGE SECTION
FRONT VIEW

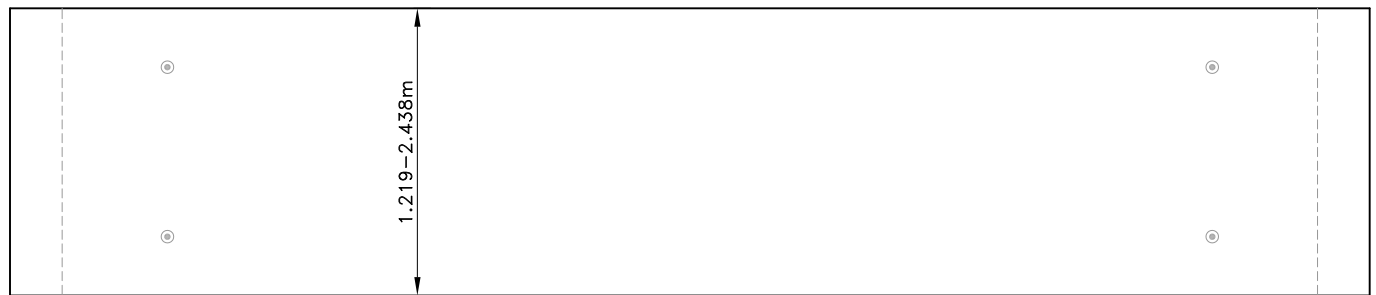

TYPICAL BRIDGE SECTION
PLAN VIEW

NOTES:

1. Designed to CHBDC CSA S6.
2. Footings can be precast with the engineer's approval.
3. Wingwalls are available with variable slopes.
3. Maximum weight per piece is 27 tonnes.
4. Dimensions will vary with soil conditions.
5. For special designs please contact our Engineering Department.
6. All dimensions are in millimeters, unless otherwise shown.

The product information contained in this document is believed to be accurate. Please note that not all products are made at all our facilities. For more information, specifics, and product availability, please contact your local sales representative.

© 2024 Rinker Materials

Rinker 013 - 03/2024

TITLE		PLANT	PROVINCE	DATE	SECTION PAGE
ForterraArch Bridge		CAMBRIDGE OTTAWA	ON	2024	F-2



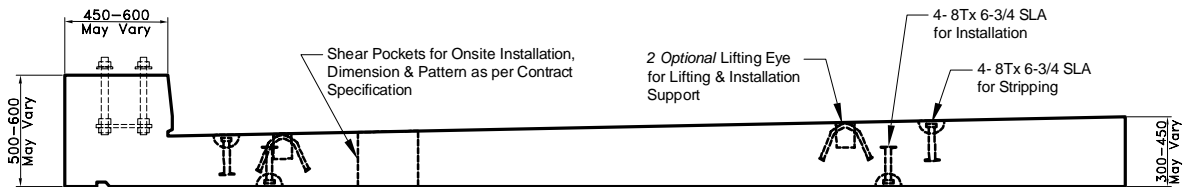
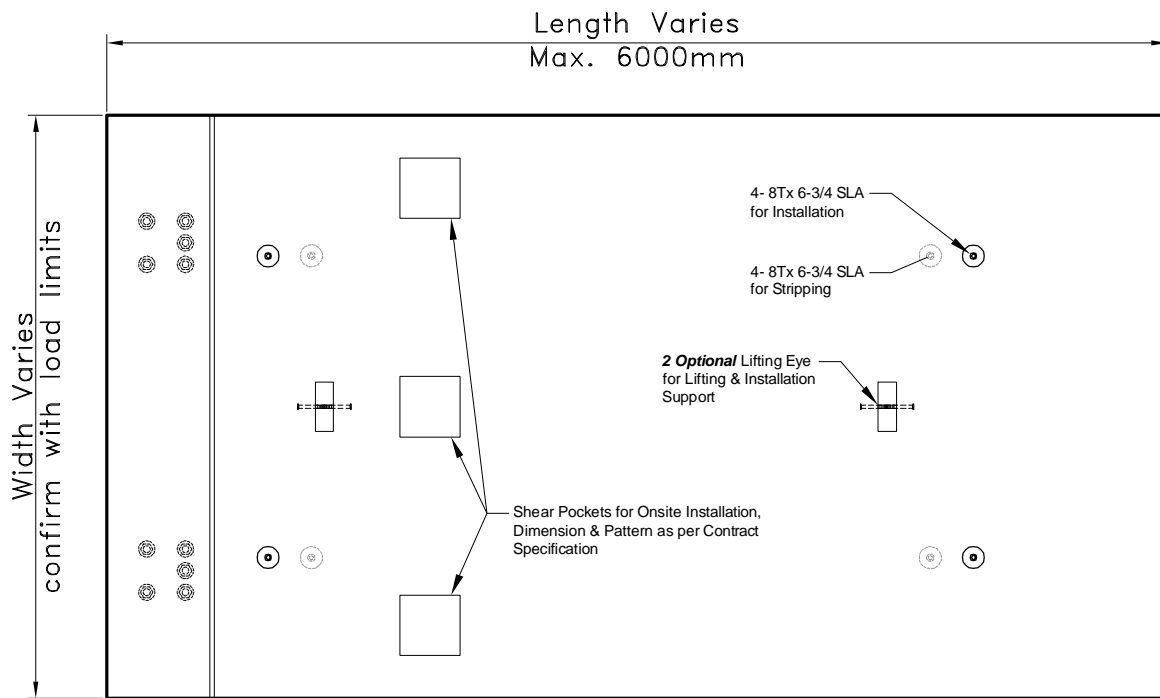

NOTES:

1. Spec:

Designed to CHBDC CSA S6-19
 Manufactured to OPSS 904
 Concrete Strength @ 28 Day = 40 MPa
 Concrete Stripping Strength = 25 Mpa

2. All dimensions are in millimeters, unless otherwise shown.

	<p>TITLE</p> <p>Precast Deck Panels</p>	<p>PLANT</p> <p>CAMBRIDGE OTTAWA</p>	<p>PROVINCE</p> <p>ON</p>	<p>DATE</p> <p>2024</p>	<p>SECTION PAGE</p> <p>F-3</p>
--	--	--	----------------------------------	--------------------------------	---------------------------------------



Founded in 1964, Rinker Materials, a QUIKRETE Company, is an industry leader in the design and manufacturing of infrastructure solutions that range from concrete pipe, box culvert, precast, bridge, and other related products.

Our pipe is available in round and elliptical shapes and in all strength classes. Our product line includes sanitary and storm sewer products, as well as water quality and interceptor chambers. Our technical resource engineers and in-house design teams are here to help you with your next job.



2099 Roseville Road
Cambridge, On
N1R 5S3
519.622.7574

3374 Rideau Road
Ottawa, On
K1G 3N4
613.822.0160

RinkerPipe.com